

## L J Series Mini Belt Spray Washer

Inline / Cellular Aqueous Spray Washer



**Most Versatile, Compact, Energy-Efficient System Available**

**Flexible Design with Up to 3 Tanks**

- Wash
- Rinse
- Rust Prevent / Seal
- Regenerative Blow Off



Return-to-Operator Robotic Load/Unload Design



\* Optional Equipment

### Ideal for

- Die Cast
- Powder Metals
- Machined Parts
- Screw Machine
- Cold Heading
- Others
- Stampings
- Deep Drawn
- Castings
- Fine Blanked
- Forging
- Gears

# JENFAB L J SERIES MINI BELT SPRAY WASHER

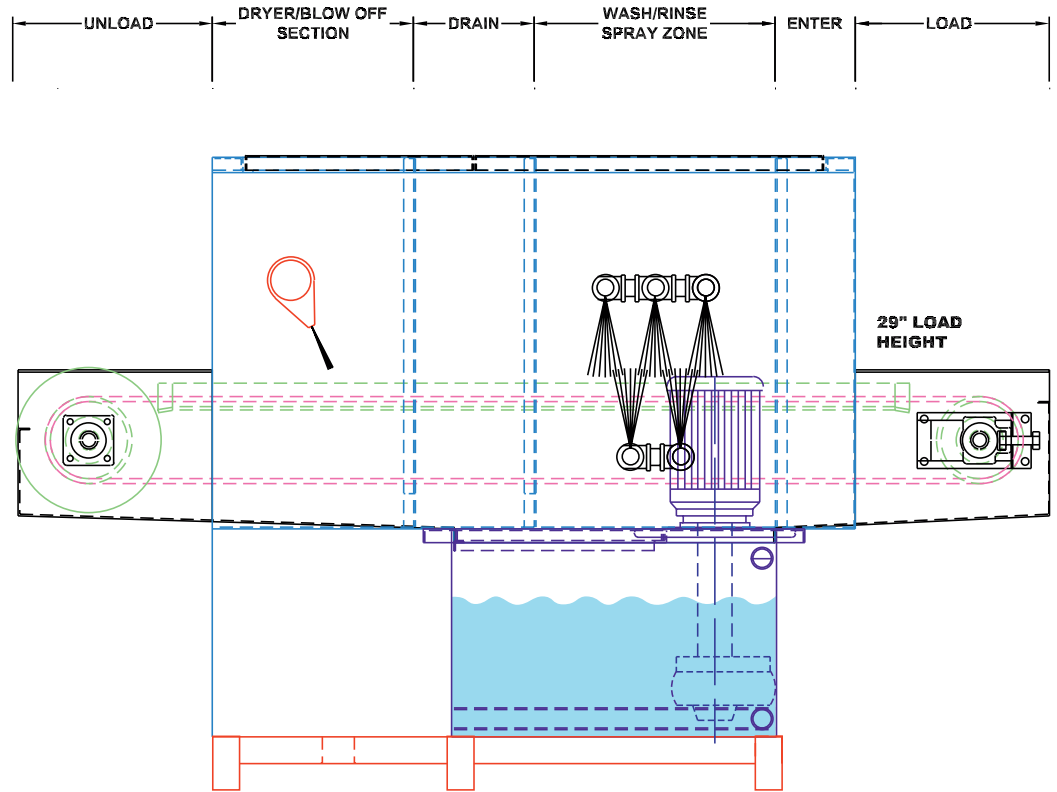
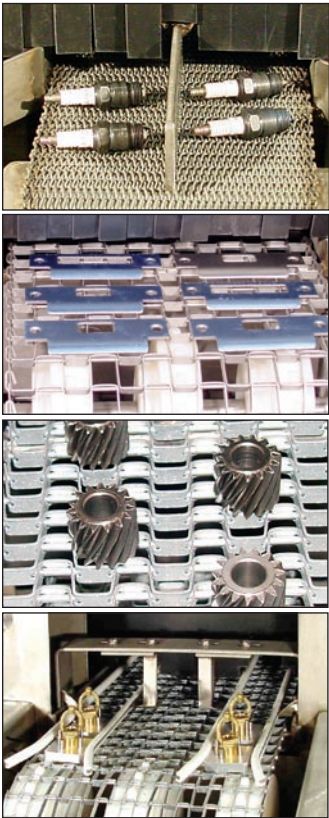

## SPECIFICATIONS

Belt Width	6" to 12"		
Tank Material	304 Stainless Steel		
Wash Tank Volume	30" DOT Tank 65 Gallons	36" DOT Tank 75 Gallons	
Rinse Tank Volume	24" DOT Tank 50 Gallons	30" DOT Tank 65 Gallons	
Wash Pump	20 - 60 GPM*	5 to 40 PSIG*	
Rinse Pump	15 - 40 GPM*	5 to 40 PSIG*	
Wash Tank Heat	140° F	Electric with Temperature Control	
Rinse Tank Heat	140° F	Electric with Temperature Control	
Regenerative Blow Off	24" DOT	Available Top and Bottom	
Overall Width	41"		* Depending on part size for energy savings

## OPTIONS

- Tank Insulation
- Chip Basket Solution Strainers
- Additional and/or Longer Tanks
- Filters
- Disc, Belt or Coalescing Oil Separator
- Tank Heat to 180° F
- PLC Control
- Stainless Pumps and Piping
- Heated Blow Off
- Variable Belt Speed
- Casters
- Return to Operator Design
- Inclined Belt Immersion and Spray Washers

*Before You Buy, Test Your Parts  
in Our Production Size Test Machines*



Distributed By:



[www.manleyequipment.com](http://www.manleyequipment.com)  
 Contact info: +1 972-839-6117  
[info@manleyequipment.com](mailto:info@manleyequipment.com)